

## **Deep Groove Ball Bearing**

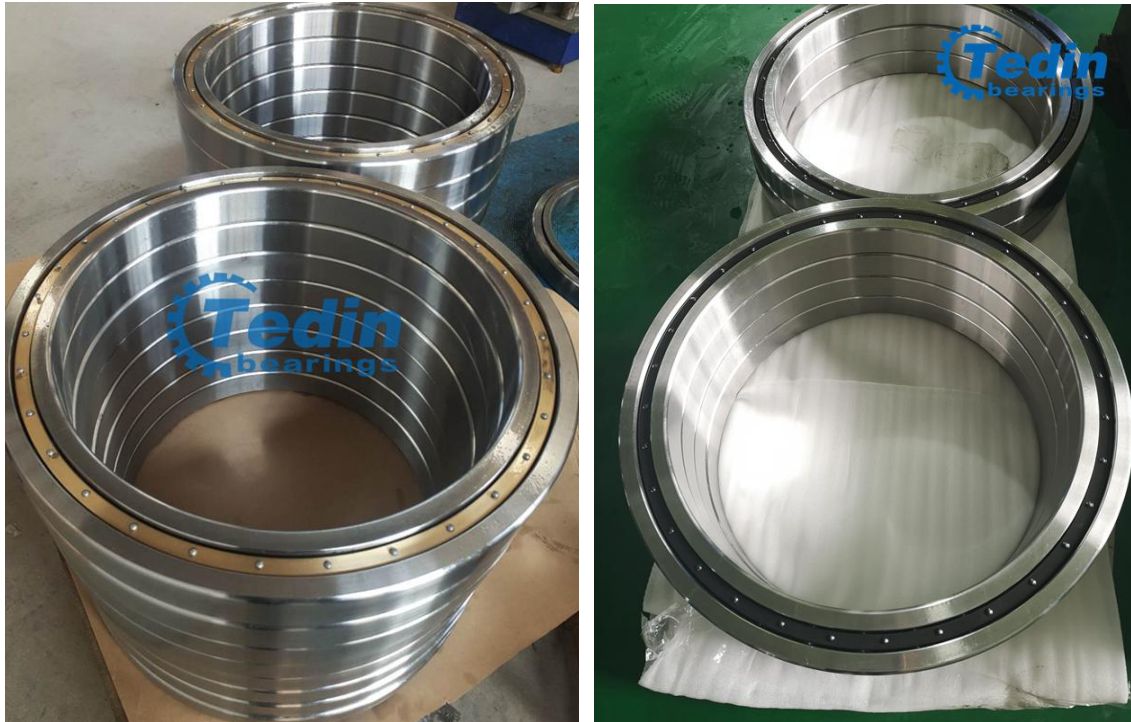

Deep groove ball bearings are mainly subjected to radial loads and can also withstand radial loads and axial loads. When it is only subjected to radial loads, the contact angle is zero. When the deep groove ball bearing has a large radial clearance, it has the performance of an angular contact bearing and can withstand a large axial load. The deep groove ball bearing has a small friction coefficient and a high limit speed.

More Options: 61800 series bearings can be protected by either metal shields (ZZ) or rubber seals (2RS). Metal shields offer dust and temperature resistance and do not affect the speed rating of the bearings. To protect bearings from



**LUOYANG TEDIN BEARING CO., LTD.**

Email: [sales@tedin-bearing.com](mailto:sales@tedin-bearing.com);  
Homepage: [www.tedin-bearing.com](http://www.tedin-bearing.com);

---

---

contamination and leakage, rubber seals are a better choice.

### **Product Features:**

1. Each ferrule of the structure deep groove ball bearing has a continuous groove type raceway with a cross section of approximately one third of the circumference of the ball. It is mainly used to withstand radial loads and also withstand certain axial loads.
2. When the radial clearance of the bearing increases, it has the property of angular contact ball bearing and can bear the axial load alternating in two directions;
3. the friction is small, the rotation speed is high;
4. The structure is simple, the manufacturing cost is low, high accuracy.

### **Application:**

Widely used in automobiles, home appliances, machine tools, motors, pumps, agricultural machinery, textile machinery and many other fields.

TEDIN produce many types of high precision deep groove ball bearings:

Precision grade: P5, P4, SP, P42

Types: Open, RS, 2RS, Z, 2Z, RZ, 2RZ, N, NR

Common Options:

2RS-- Two Rubber Seals

C0-- Normal Internal Clearance

C3-- Greater than normal clearance

M-- Brass Cage

NR-- Snap Ring

P53-- Abec 5 with C3 clearance

ZZ-- Two Metal Shields

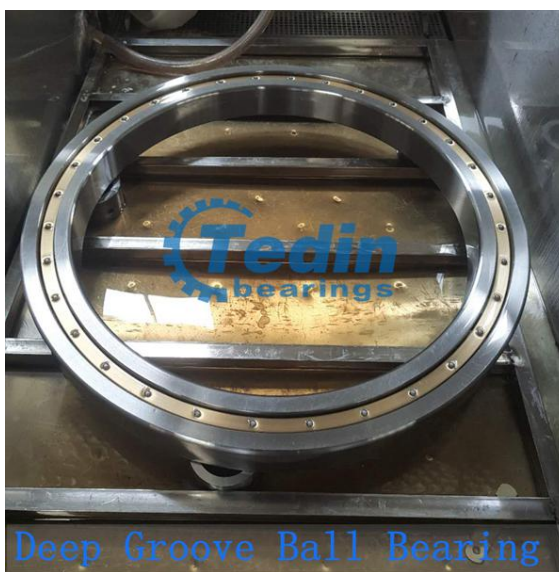
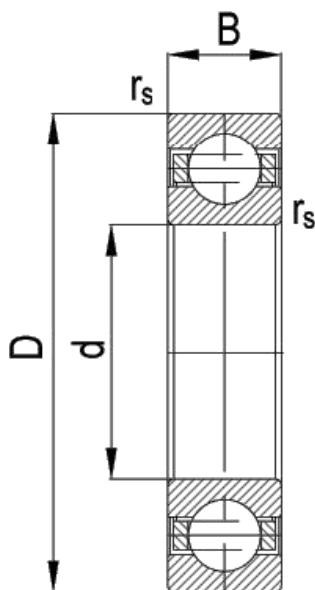

Dimensions				Basic Load Rating		Designation	Weight	Installation Size			Limiting Speed		
mm				kN				kg	mm			r/min	
d	D	B	r <sub>min</sub>	C <sub>r</sub>	C <sub>or</sub>				d <sub>amin</sub>	D <sub>amax</sub>	r <sub>amax</sub>	Grease	Oil
100	125	13	1	19.6	21.2	61820	0.31	105	120	1	4800	5700	
110	140	16	1	28.1	30.7	61822	0.61	115	135	1	4300	5100	
120	150	16	1	29	33	61824	0.66	125	145	1	4000	4700	
130	165	18	1.1	36.9	41.2	61826	0.94	136.5	158.5	1	3600	4300	
140	175	18	1.1	38.2	44.4	61828	1	146.5	168.5	1	3400	4000	



**LUOYANG TEDIN BEARING CO., LTD.**

Email: [sales@tedin-bearing.com](mailto:sales@tedin-bearing.com);  
 Homepage: [www.tedin-bearing.com](http://www.tedin-bearing.com);

150	190	20	1.1	49.1	58.5	61830	1.15	156.6	183.5	1	3000	3600
160	200	20	1.1	48.5	61	61832	1.23	166.5	193.5	1	2800	3400
170	215	22	1.1	61.5	78	61834	1.9	176.5	208.5	1	2600	3200
180	225	22	1.1	62.3	78.5	61836	1.72	186.5	218.5	1	2400	3000
190	240	24	1.5	75.1	93.5	61838	2.53	198	232	1.5	2200	2800
200	250	24	1.5	74	98	61840	2.67	208	242	1.5	2200	2800
220	270	24	1.5	76.5	97.8	61844	2.9	228	262	1.5	1900	2400
240	300	28	2	83.5	108	61848	4.48	249	291	2	1800	2200
260	320	28	2	101	148	61852	4.84	269	311	2	1700	2000
280	350	33	2	133	191	61856	7.2	289	341	2	1600	1900
300	380	38	2.1	166	233	61860	10.3	311	369	2	1400	1700
320	400	38	2.1	168	244	61864	10.8	331	389	2	1300	1600
340	420	38	2.1	175	265	61868	11.5	351	409	2	1200	1500
360	440	38	2.1	192	290	61872	11.8	371	429	2	1100	1400
380	480	46	2.1	238	375	61876	19.5	391	469	2	1000	1300
400	500	46	2.1	241	390	61880	20.5	411	489	2	1000	1300
420	520	46	2.1	245	410	61884	21.4	431	509	2	950	1200
440	540	46	2.1	249	425	61888	22.3	451	529	2	900	1100
460	580	56	3	310	550	61892	34.3	473	567	2.5	900	1100
480	600	56	3	315	575	61896	35.4	493	587	2.5	850	1000
500	620	56	3	320	600	618/500	37.2	513	607	2.5	800	950
530	650	56	3	325	625	618/530	39.8	543	637	2.5	750	900
560	680	56	3	330	650	618/560	41.5	573	667	2.5	700	850
600	730	60	3	355	735	618/600	50.9	613	717	2.5	670	800
630	780	69	4	420	890	618/630	71.3	646	767	3	630	750
670	820	69	4	435	965	618/670	75.4	686	807	3	560	670
710	870	74	4	480	1100	618/710	92.6	726	854	3	530	630
750	920	78	5	525	1260	618/750	110	770	900	4	500	600
800	980	82	5	530	1310	618/800	132	820	960	4	450	530
850	1030	82	5	559	1430	618/850	140	868	1012	4	410	470
900	1090	85	5	618	1532	618/900	160	920	1070	4	350	410
950	1150	90	5	637	1730	618/950	190	968	1132	4	290	350

Luoyang Tedin Bearing Co., Ltd.



**LUOYANG TEDIN BEARING CO., LTD.**

Email: [sales@tedin-bearing.com](mailto:sales@tedin-bearing.com);  
Homepage: [www.tedin-bearing.com](http://www.tedin-bearing.com);

---

Mobile: 0086 136 6388 9399;

WeChat: 0086 136 63889399;

Tel: 0086 379 6730 1199 ;

Skype: lysnzc;

Instagram: rollerbearings;

Email: [sales@tedin-bearing.com](mailto:sales@tedin-bearing.com);

Website: [www.tedin-bearing.com](http://www.tedin-bearing.com);

